



REF: # 9914

TORRE PACHECO



INFO

PRICE: 308.000 €

PROPERTY TYPE: Villa

CITY: Torre Pacheco

BEDROOMS: 3

Bathrooms: 2

Build (m2): 86

Plot (m2): 168

Terrace (m2): 91

Year:

Floor: -

Old price -

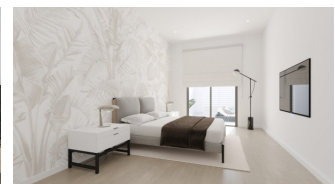

DESCRIPTION

WONDERFUL NEW BUILD ONE LEVEL "BREATHE" VILLA IN BALSICAS, MURCIA - with private pool and solarium! This 86m2 detached villa built on a plot of 168m2 across one level consists of 3 bedrooms, 2 bathrooms, open plan fully-fitted kitchen and lounge-dining room, with terraced area, private pool, parking on the plot and solarium with Summer kitchen, to enjoy all hours of sunshine every day of the year. The property has been designed with a contemporary style, meets the highest standards and is equipped with an equipped kitchen completely furnished including oven, integrated fridge and dishwasher, hob and extractor fan plus Kitchen island work zone. It benefits from; Lighting: inside the property (dining room, kitchen, corridors and bathrooms), and as well as in outdoor areas. Lined wardrobes with drawers. Fully fitted bathrooms with toilet, vanity unit, mirror and shower with screen panels. Pre-installation for ducted air conditioning. Solarium with Summer kitchen, with pre-installation for appliances and sliding doors. Private pool with external shower. Parking space on the plot. Balsicas is a perfect place for golf lovers and also for anyone who enjoys green spaces as places of leisure, beauty and tranquillity. Its strategic

location makes it possible for the family that decides to live in this complex to have at their fingertips everything that anyone could wish for: a climate where the sun shines almost all year round, nearby beaches, the Mar Menor and its natural muds. with proven healing powers. Complex located 20 minutes from Murcia - Corvera airport and 1 hour from Alicante airport.



STYLE <ul style="list-style-type: none">• Modern• Contemporary	VIEWS <ul style="list-style-type: none">• Panoramic views	AIRCONDITIONING <ul style="list-style-type: none">• Central airconditioning	DISTANCE TO : <div>Beach : +10 Km</div> <div>Airport: 20 Km</div>
PARKING <div>Parking no Cars: 1</div>	MAIN LIVING AREA <ul style="list-style-type: none">• Bathroom en-suite	FLOORING <ul style="list-style-type: none">• Tile floors• Stone floors	KITCHEN <ul style="list-style-type: none">• Open kitchen• Equipped kitchen
GARDEN AND TERRACES <ul style="list-style-type: none">• Open terrace• Exterior lights• Fenced• Outdoor kitchen• Private garden	EXTRA <ul style="list-style-type: none">• Built in wardrobes• Reinforced door• Double glazed windows		









PLANTA BAJA



PLANTA SOLARIUM

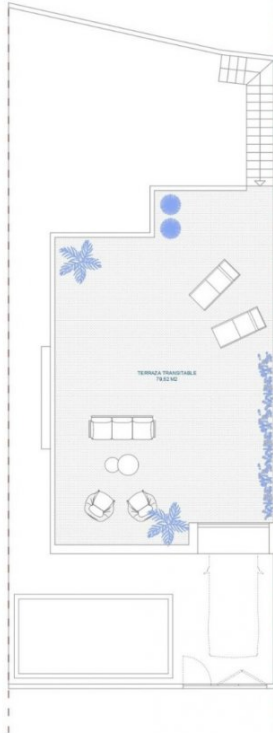

PLANTA BAJA GENERAL



PARCELAS	SUP. PARCELA
VIVIENDA 01	196.52 M2
VIVIENDA 02	197.94 M2
VIVIENDA 03	193.40 M2
VIVIENDA 04	193.94 M2
VIVIENDA 05	178.61 M2





"OUR EXPERIENCE IS YOUR GUARANTEE"