



REF: # 8981

BENITACHELL



INFO

PRICE: 785.000 €

PROPERTY TYPE: Villa

CITY: Benitachell

BEDROOMS: 3

Bathrooms: 2

Build (m2): 481

Plot (m2): 1.118

Terrace (m2): -

Year: -

Floor: -

Old price -



DESCRIPTION

The villas in Magnolias Sunset residential estate are in a privileged location, combining privacy, unique views of the sea and location in the heart of the Cumbre del Sol Residential Resort, an exclusive place to live in and enjoy your holidays. The 238m2 properties have 3 bedrooms, 2 bathrooms, a modern kitchen with an independent pantry, living rooms with direct access to a terrace and garden as well as a ground floor studio that can be used as an additional bedroom or to create an independent residence. An architectural design that perfectly merges indoors and outdoors, the harmonic architecture manages to blend its volume into the surroundings, providing privacy and unique sea views that make these houses singular.

ENERGETIC CERTIFIED



KITCHEN

- Equipped kitchen







MODELO		ESTILO		CALIDAD					
HIEDRA		CONTEMPORANEO PLUS							
OBSERVACIONES		PORTON		SUPERFICIES CONSTRUIDAS		NUMERO PLANO		CLIENTE	
ESCALON EN SALIDAS AL EXTERIOR VENTILACIONES A 20cm DEL TECHO. FUECOS AL VADO (1-2 15cm) PROTEGIDOS CON BARRANDA METALICA.		ALU COLOR NEGRO		VACO SANITARIO		72.95 m ²		56802	
				PORCHE 2		9.90 m ²			
		CARPINTERIA		SALA MAQUINAS		13.35 m ²			
		ALU COLOR NEGRO				FECHA		PARCELA	
		274 EF				11-09-17		118-M LA CUMBRE DEL SOL	

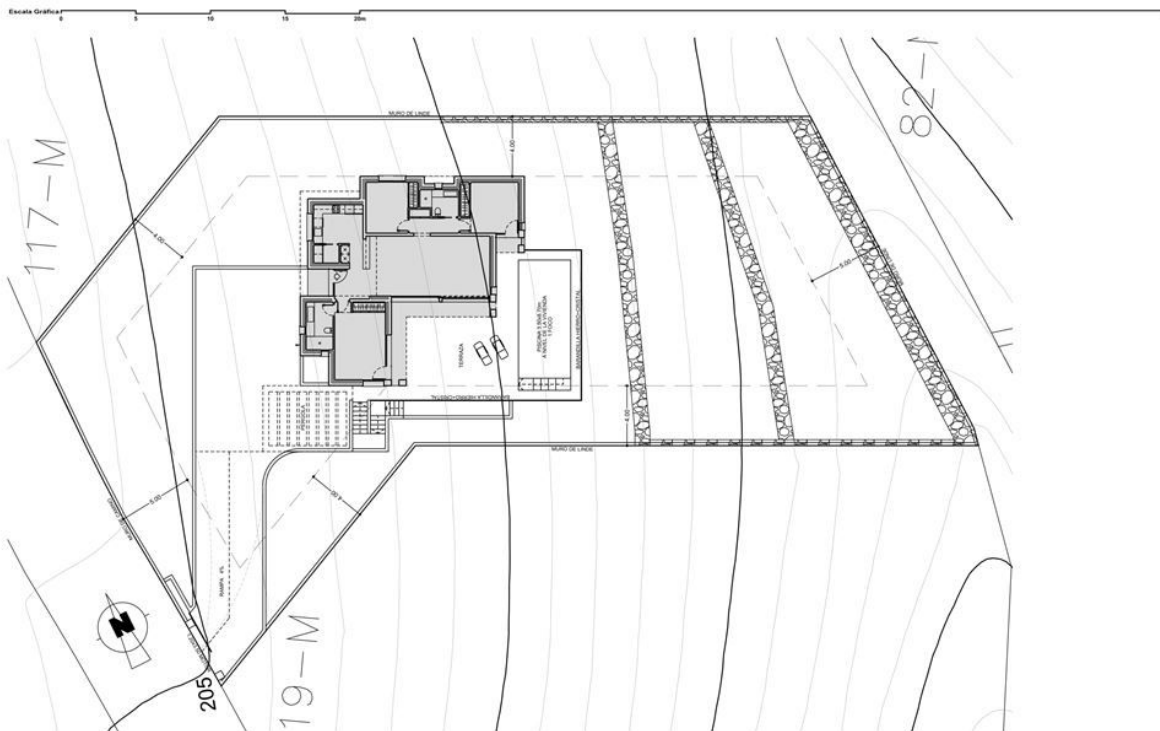

RESIDENCIAL MAGNOLIAS SUNSET		LA CUMBRE DEL SOL		VAPF	
OBSERVACIONES ESCALÓN EN SALIDAS AL EXTERIOR VENTILACIONES A 20cm. DEL TECHO.		SUPERFICIES CONSTRUIDAS PARCELA TERRAZA PERGOLA RAMPA	1341.00 m ² 56.65 m ² 29.40 m ² 147.00 m ²	NÚMERO PLANO 56717	CLIENTE GARSIVA, S.L.
				FECHA 31-07-17	PARCELA 118-M

"OUR EXPERIENCE IS YOUR GUARANTEE"