



REF: # 4547

LA NUCIA/POLOP (LA NUCIA CENTRO)



INFO

PRICE:	149.000 €
PROPERTY TYPE:	Villa
CITY:	La Nucia/Polop (La Nucia Centro)
BEDROOMS:	1
Bathrooms:	1
Build (m2):	70
Plot (m2):	1.800
Terrace (m2):	60
Year:	
Floor:	1
Old price	-



DESCRIPTION

Countryside villa with mountain views. It has 1800m of fenced land with fruit trees and natural grass. Sun all day and very private. Walking distance to La Nucia center. Livingroom with fireplace, new open citchen, all very bright. Bathroom with shower in new style. Southfacing terrace, barbeque area. Reacently big reforms, new doble glased windows, insulation in flloor, walls and roof. Floor heating and aircondition heatpump. New gate parking for 3 cars inside the plot

ENERGETIC CERTIFIED



STYLE	AIRCONDITIONING	DISTANCE TO :	ORIENTATION
<ul style="list-style-type: none">Contemporary	<ul style="list-style-type: none">LivingroomKitchen	Beach : 5 Km Airport: 60 Km Town center : 1 Km	South
FURNITURE	PARKING	TAX	FLOORING
<ul style="list-style-type: none">Not furnished	Parking no Cars: 3	I.B.I : 181 €	<ul style="list-style-type: none">Tile floors
KITCHEN	GARDEN AND TERRACES	HEATING	EXTRA
<ul style="list-style-type: none">Open kitchenEquipped kitchen	<ul style="list-style-type: none">Open terraceFruit treesPalm treesLandscapedFencedLawnStone wallsBBQ/grillPrivate garden	<ul style="list-style-type: none">Floor heatingFloor heating bathroomsFireplace wood	<ul style="list-style-type: none">Reinforced doorDouble glazed windowsSatellite TVInternet













COLEGIO OFICIAL DE APAREJADORES, ARQUITECTOS TÉCNICOS
E INGENIEROS DE EDIFICACIÓN DE ALICANTE

10-08930

VISADO

02291 JOSE CHACON MESA

El colegio garantiza la firma digital de este documento

Página 1 de 1

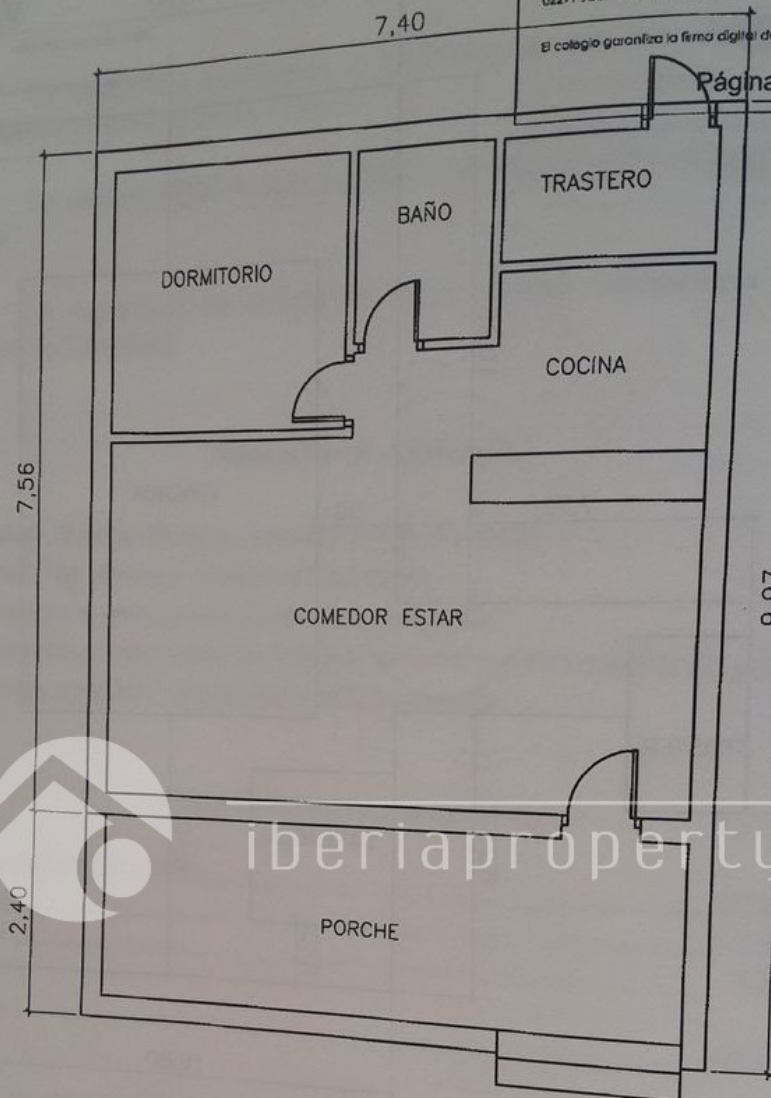

SUP. CONST. CERRADA= 55,94 M2
 SUP. CONST. PORCHE= 17,90 M2/2=8,95 M2
 SUP. CONSTRUIDA TOTAL= 64,89 M2

PROMOTOR	ESTEBAN TOME MORAL
PROYECTO	CERTIFICADO SUPERFICIES
SITUACION	PTDA. ALMARCH, POLG. 16, PCLA. 148, LA NUCIA, ALICANTE
PLANO	COTAS Y SUPERFICIES VIVIENDA
FECHA	AGOS 2010
EXP.	A10CER15
ESCALA	1:75
Nº PLANO	02

OFITECNIC
ARQUITECTURA

OFITECNIC ARQUITECTURA S.L. Colg. 9036
 ARQ. TEL. JOSE CHACON MESA Colg. 2291
 C/Goya nº 1, 1º B, 03002 Benidorm, Alicante
 Telf. y Fax: 96 535 5059 Movil: 689 592 964
 www.ofitecnic.com / ofitecnic@ofitecnic.com