



REF: # 10446

ORIHUELA COSTA (VISTABELLA GOLF COURSE )



#### INFO

PRICE:	209.900 €
PROPERTY TYPE:	Townhouse
CITY:	Orihuela Costa (Vistabella Golf Course )
BEDROOMS:	2
Bathrooms:	2
Build ( m2 ):	76
Plot ( m2 ):	178
Terrace ( m2 ):	59
Year:	-
Floor:	-
Old price	-



#### DESCRIPTION

FANTASTIC NEW BUILD SEMI DETACHED VILLA IN VISTABELLA GOLF with private garden and an option or a pool! This 76m2 semi-detached villa is built on one floor and consists of 2 bedrooms, 2 bathrooms, storage room, laundry room, 178m2 private garden, 24m2 terrace, a large 35m2 private solarium and an option of a pool at an additional cost. The villa is of modern design with Mediterranean character, which offers you spaciousness, comfort and luminosity, with high-end qualities. The spectacular Vistabella Golf resort has a countryside and nature environment, it is very close to the golf course, with all the services one needs. This Resort is located in a privileged place in Orihuela, where you can enjoy the quality of life that the Costa Blanca offers you. It has all the local amenities such as shops, bars, restaurants and the club house less than 5 minutes walk away. You can enjoy excellent sports facilities such as paddle tennis, bowling and championship golf courses. Close to the towns of San Miguel de Salinas

and Los Montesinos, which are a five minute drive away and the blue flag beaches of Guardamar are just a 15 minute drive away. Alicante Airport is 35 minutes away and Murcia (Corvera) Airport 30 minutes away.



#### STYLE

- Modern
- Mediterranean

#### VIEWS

- Panoramic views

#### AIRCONDITIONING

- Central airconditioning

#### DISTANCE TO :

Beach : +10 Km

Airport: 70 Km

#### PARKING

Parking no Cars: 1

#### FLOORING

- Tile floors
- Stone floors

#### GARDEN AND TERRACES

- Open terrace
- Private garden

#### EXTRA

- Double glazed windows
- Storage room
- Laundry room





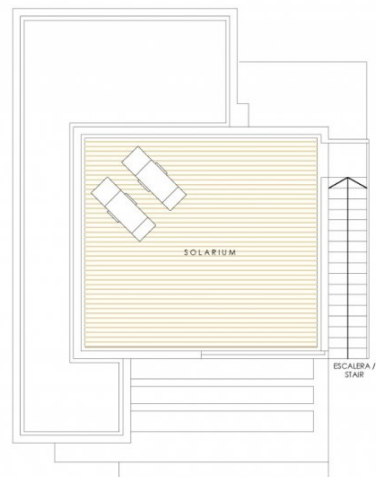

VIVIENDA 23  
SUPERFICIES ÚTILES / OCCUPABLE AREA

SALÓN-COCINA / LIVING ROOM-KITCHEN	36.76 m <sup>2</sup>
BAÑO 1 / BATHROOM 1	3.85 m <sup>2</sup>
BAÑO 2 / BATHROOM 2	4.72 m <sup>2</sup>
LAVADERO / LAUNDRY	2.05 m <sup>2</sup>
DORMITORIO 1 / BEDROOM 1	11.94 m <sup>2</sup>
DORMITORIO 2 / BEDROOM 2	10.65 m <sup>2</sup>
DISTRIBUIDOR / CORRIDOR	3.37 m <sup>2</sup>
TRASTERO / STORAGE	0.78 m <sup>2</sup>
TERRAZA 1 / TERRACE 1	16.94 m <sup>2</sup>
TERRAZA 2 / TERRACE 2	7.70 m <sup>2</sup>
ESCALERA / STAIR	5.98 m <sup>2</sup>
SOLARIUM	35.82 m <sup>2</sup>
SUP. CERRADA / CLOSED AREA	84.22 m <sup>2</sup>
CLOSED AREA + TERRACE + SOLARIUM	144.68 m <sup>2</sup>
JARDÍN / PLOT	178.00 m <sup>2</sup>

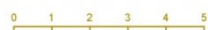

















***"OUR EXPERIENCE IS YOUR GUARANTEE"***