



REF: # 6717

COSTA MURCIA (SAN PEDRO DEL PINATAR)



INFO

PRICE:	245.950 €
PROPERTY TYPE:	Apartment
CITY:	Costa Murcia (San Pedro del Pinatar)
BEDROOMS:	3
Bathrooms:	2
Build (m2):	98
Plot (m2):	-
Terrace (m2):	6
Year:	
Floor:	-
Old price	-

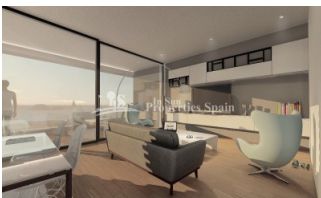

DESCRIPTION

New beachfront boutique Apartment development in SAN PEDRO with stunning beach and sea views from the terraces. Generous build sizes from 98m2 and an open plan living space with the option to customise the Apartment with either 2 or 3 bedrooms. They boast open living area, fitted kitchen with oven, hob and extractor hood, 2 bathrooms and terrace. There is the option to have a garage space for an additional €150000 and an optional storage room (perfect for housing all of the beach equipment) for an additional €4000. The two Penthouse Apartments are already SOLD. Remaining Apts are on the 1st or 2nd floor but the development is Lift assisted. Lo Pagan is situated on the north shore of the Mar Menor with a beautiful beach, promenade and small marina. During the summer months there is a lively funfair beside the marina which adds to the seaside atmosphere. Lo Pagan is most famous for its mud baths. These are free and are located at the end of the beach and the start of the salinas walking and cycling route out to

sea. When you own a home in this region we would recommend a visit Cabo de Palos, Punta Brava or any of the other interesting towns and villages on the Mar Menor.

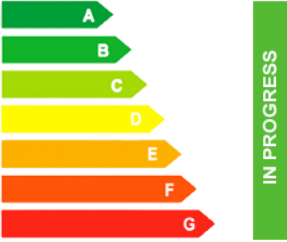

STYLE	VIEWS	DISTANCE TO :	ORIENTATION
<ul style="list-style-type: none"> Modern Contemporary 	<ul style="list-style-type: none"> Panoramic views Sea views 	Beach : 50 m Airport: 40 Km Town center : 100 m	South
FURNITURE	PARKING	MAIN LIVING AREA	FLOORING
<ul style="list-style-type: none"> Not furnished 	Parking no Cars: 1	<ul style="list-style-type: none"> Storage 	<ul style="list-style-type: none"> Tile floors Stone floors
KITCHEN	GARDEN AND TERRACES	EXTRA	ENERGETIC CERTIFIED
<ul style="list-style-type: none"> Open kitchen Equipped kitchen 	<ul style="list-style-type: none"> Open terrace 	<ul style="list-style-type: none"> Reinforced door Double glazed windows Lift 	 <p>The image shows a vertical energy efficiency scale with seven horizontal bars labeled A through G. The bars are colored in a gradient from dark green at the top to red at the bottom. A vertical green bar on the right side of the scale is labeled 'IN PROGRESS'.</p>

"OUR EXPERIENCE IS YOUR GUARANTEE"