



REF: # 9734

PILAR DE LA HORADADA



#### INFO

**PRICE:** 239.900 €

**PROPERTY TYPE:** Apartment

**CITY:** Pilar De La Horadada

**BEDROOMS:** 2

**Bathrooms:** 2

**Build ( m2 ):** 84

**Plot ( m2 ):** 30

**Terrace ( m2 ):** 13

**Year:** -

**Floor:** -

**Old price** -



#### DESCRIPTION

NEW BUILD MODERN RESIDENTIAL COMPLEX APARTMENT GROUND FLOOR IN PILAR DE LA HORADADA. This 84 m2 ground floor apartment consists of 2 bedrooms, 2 bathrooms, a 13m2 private terrace and large 30m2 private garden with an impressive communal rooftop pool area. Each apartment comes with a garage space in the basement. The building has a commercial space on the ground floor. The development is located in an unbeatable enclave within a large residential area of Pilar de la Horadada, a privileged place to families for easy access to all kinds of services. Pilar de la Horadada is a typical Spanish village in the most southern part of the Costa Blanca. The large main street has supermarkets, lots of shops, restaurants and bars and some lovely squares. In addition to the original established Golf courses on the Orihuela Costa Villamartin, Las Ramblas, Real Campoamor and Las Colinas approximately 14km away, Pilar de la Horadada is also well served with the excellent course Lo Romero only 4.2km drive. Only 8.2km away between San Javier and San Pedro del Pinatar, is Dos Mares shopping centre, and the major shopping centres of Murcia and

Cartagena are also both under an hour's drive away. Further towards the Orihuela Costa, only a 15 minute journey you will find "La Zenia Boulevard" the largest shopping centre in the Alicante region. The beautiful beaches of Torre de la Horadada and Mil Palmeras with fine sand promenade is just 5 minutes away. The airports of Corvera (Murcia) and Alicante are respectively 40 and 55 minutes away.



STYLE

- Modern

DISTANCE TO :

Beach : 4 Km

Airport: 50 Km

PARKING

Parking no Cars: 1

GARDEN AND  
TERRACES

- Open terrace
- Private garden

EXTRA

- Reinforced door











## PL. BAJA

### 2 DORMITORIOS



#### SUPERFICIES CONSTRUIDA

Vivienda	84,60 m <sup>2</sup>
Porche	30,15 m <sup>2</sup>
Patios	12,44 m <sup>2</sup>
<b>TOTAL</b>	<b>127,19 m<sup>2</sup></b>



## PLANTA BAJA/GROUND FLOOR



## PLANTA PRIMERA/FIRST FLOOR



## PLANTA ÁTICO/ATTIC FLOOR

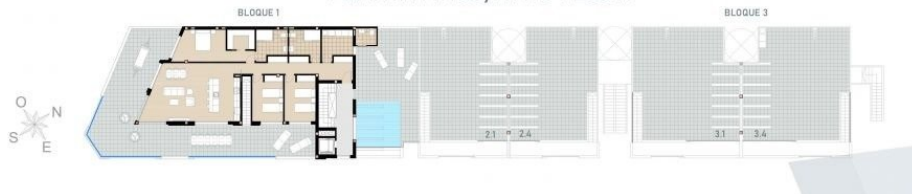















***"OUR EXPERIENCE IS YOUR GUARANTEE"***