



REF: # 7317

FINESTRAT (FINESTRAT HILLS)



#### INFO

PRICE:	199.000 €
PROPERTY TYPE:	Apartment
CITY:	Finestrat (Finestrat Hills)
BEDROOMS:	2
Bathrooms:	2
Build ( m2 ):	79
Plot ( m2 ):	56
Terrace ( m2 ):	27+56
Year:	
Floor:	-
Old price	-

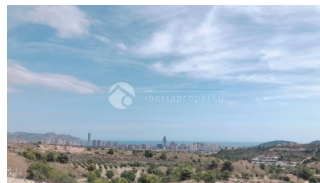
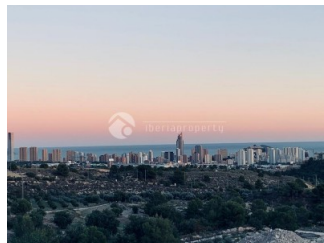

#### DESCRIPTION

16 NEW APARTMENTS DIVIDED ON 3 BLOCKS - ALL WITH GREAT VIEWS IN FINESTRAT HILLS CAMPAIGN: ALL APPLIANCES ARE INCLUDED The ground floor apartments consist of 2 bedrooms and 2 bathrooms, open living and kitchen solution terrace of 27 sqm. Private garden of 56 sqm. Fully equipped kitchen with quarts worktop, steel sink, hob, kitchen fan. Bathroom decoration with mirror and light. Shower enclosures. Built-in wardrobe. TV telephone and internet outlets in the living room, on the terrace and in all bedrooms. Electric blinds in the bedrooms Heating cables in all bathrooms. Pre-installation of air conditioning / heat pump, with balanced ventilation in all rooms. Airothermia for production of tap water / hot water. Anti-slip tiles on all terraces. Outdoor area with communal pool green area. A 10-year guarantee is given for hidden defects and faults.

#### ENERGETIC CERTIFIED



<b>STYLE</b>	<b>VIEWS</b>	<b>AIRCONDITIONING</b>	<b>DISTANCE TO :</b>
<ul style="list-style-type: none"><li>• Modern</li></ul>	<ul style="list-style-type: none"><li>• Panoramic views</li><li>• Sea views</li><li>• Mountain views</li></ul>	<ul style="list-style-type: none"><li>• Central airconditioning</li></ul>	Beach : 4 Km <hr/> Airport: 40 Km <hr/> Town center : 2 Km
<b>ORIENTATION</b>	<b>MAIN LIVING AREA</b>	<b>FLOORING</b>	<b>KITCHEN</b>
South	<ul style="list-style-type: none"><li>• Bathroom en-suite</li></ul>	<ul style="list-style-type: none"><li>• Tile floors</li></ul>	<ul style="list-style-type: none"><li>• Open kitchen</li><li>• Equipped kitchen</li></ul>
<b>GARDEN AND TERRACES</b>	<b>HEATING</b>	<b>EXTRA</b>	
<ul style="list-style-type: none"><li>• Covered terrace</li><li>• Open terrace</li><li>• Exterior lights</li><li>• Automatic watering system</li><li>• Palm trees</li><li>• Landscaped</li><li>• Communal Garden</li></ul>	<ul style="list-style-type: none"><li>• Floor heating bathrooms</li></ul>	<ul style="list-style-type: none"><li>• Built in wardrobes</li><li>• Reinforced door</li><li>• Double glazed windows</li></ul>	









## BALCÓN DE FINESTRAT

16 VIVIENDAS + PISCINAS + APARCAMIENTO



# BALCÓN DE FINESTRAT

16 VIVIENDAS + PISCINAS + APARCAMIENTO



## BALCÓN DE FINESTRAT

16 VIVIENDAS + PISCINAS + APARCAMIENTO

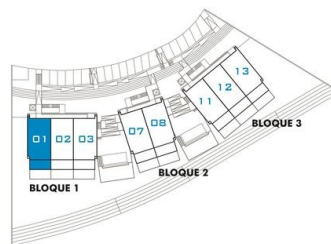

### BLOQUE 1 - VIVIENDA 01

SUP. CONSTRUIDA VIVIENDA (PORCHE CUBIERTO 50%) 79.50 m<sup>2</sup>  
m<sup>2</sup> TERRAZA DESCUBIERTA 27.00 m<sup>2</sup>

m<sup>2</sup> TOTALES 106.50 m<sup>2</sup>

m<sup>2</sup> PARCELA PRIVATIVA 56.00 m<sup>2</sup>



PLANTA BAJA (1/75) DIN A3



PARCELA PRIVATIVA (1/75)

## BALCÓN DE FINESTRAT

16 VIVIENDAS + PISCINAS + APARCAMIENTO

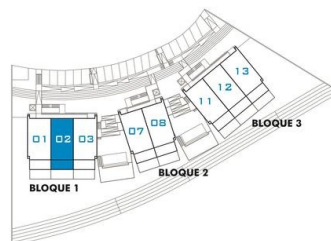

### BLOQUE 1 - VIVIENDA 02

SUP. CONSTRUIDA VIVIENDA (PORCHE CUBIERTO 50%) 77.80 m<sup>2</sup>  
m<sup>2</sup> TERRAZA DESCUBIERTA 27.00 m<sup>2</sup>

m<sup>2</sup> TOTALES 104.80 m<sup>2</sup>

m<sup>2</sup> PARCELA PRIVATIVA 56.00 m<sup>2</sup>



PLANTA BAJA (1/75) DIN A3



PARCELA PRIVATIVA (1/75)

## BALCÓN DE FINESTRAT

16 VIVIENDAS + PISCINAS + APARCAMIENTO

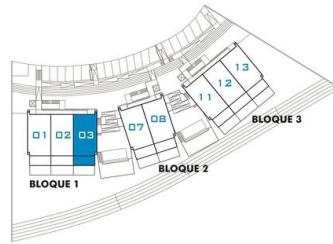

### BLOQUE 1 - VIVIENDA 03

SUP. CONSTRUIDA VIVIENDA (PORCHE CUBIERTO 50%) 79.50 m<sup>2</sup>  
m<sup>2</sup> TERRAZA DESCUBIERTA 27.00 m<sup>2</sup>

m<sup>2</sup> TOTALES 106.50 m<sup>2</sup>

m<sup>2</sup> PARCELA PRIVATIVA 56.00 m<sup>2</sup>



PLANTA BAJA (1/75) DIN A3

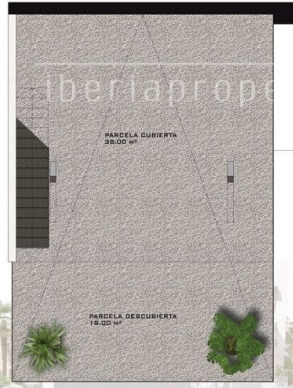

PARCELA PRIVATIVA (1/75)

## BALCÓN DE FINESTRAT

16 VIVIENDAS + PISCINAS + APARCAMIENTO

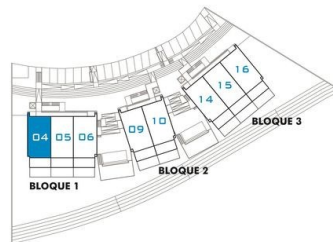

### BLOQUE 1 - VIVIENDA 04

SUP. CONSTRUIDA VIVIENDA 71.20 m<sup>2</sup>  
m<sup>2</sup> TERRAZAS 17.50 m<sup>2</sup>

m<sup>2</sup> TOTALES 88.70 m<sup>2</sup>

m<sup>2</sup> SOLARIUM 68.00 m<sup>2</sup>



PLANTA PISO (1/75) DIN A3



SOLARIUM (1/75)

## BALCÓN DE FINESTRAT

16 VIVIENDAS + PISCINAS + APARCAMIENTO

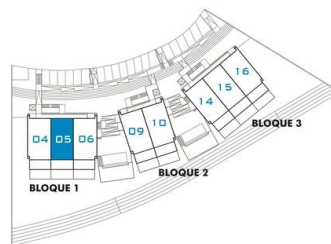

### BLOQUE 1 - VIVIENDA 05

SUP. CONSTRUIDA VIVIENDA 69.30 m<sup>2</sup>  
m<sup>2</sup> TERRAZAS 17.50 m<sup>2</sup>

m<sup>2</sup> TOTALES 86.80 m<sup>2</sup>

m<sup>2</sup> SOLARIUM 68.00 m<sup>2</sup>



PLANTA PISO (1/75) DIN A3



SOLARIUM (1/75)



## BALCÓN DE FINESTRAT

16 VIVIENDAS + PISCINAS + APARCAMIENTO

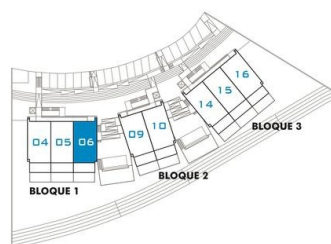

### BLOQUE 1 - VIVIENDA 06

SUP. CONSTRUIDA VIVIENDA 71.20 m<sup>2</sup>  
m<sup>2</sup> TERRAZAS 17.50 m<sup>2</sup>

m<sup>2</sup> TOTALES 88.70 m<sup>2</sup>

m<sup>2</sup> SOLARIUM 68.00 m<sup>2</sup>



PLANTA PISO (1/75) DIN A3



SOLARIUM (1/75)



"OUR EXPERIENCE IS YOUR GUARANTEE"